

Application is hereby made to the Sonoma County Health Officer for a permit to construct or repair a sewage disposal system as described below in compliance with the code of Sonoma County or for clearance for other construction.

This permit application must be signed on all 3 signature lines by the same person (i.e. contractor or owner/builder). A letter of authorization from owner must accompany this application if agent is signing on owner's behalf.

APPLICANT'S SIGNATURE: Sander A. Torgerson DATE ISSUED: 9/28/95 CLEARANCE: 18117

JOB ADDRESS: 7620 TARBWATER RD.
 NEAREST CROSS STREET: ST. HELENA RD.
 ASSESSOR'S PARCEL NO.: 28-17-64

OWNER'S NAME: SANDER A. TORGERSON
 MAILING ADDRESS: PO BOX 133
 CITY: SANTA ROSA STATE: CA ZIP: 95903 PHONE NUMBER: 539-9773

SUBDIVISION: SANTA ROSA LOT: BLK. 1
 CITY: SANTA ROSA STATE: CA ZIP: 95404

INSTALLATION WILL SERVE:
 RESIDENCE APARTMENT HOUSE COMMERCIAL MOBILE HOME
 MOTEL OTHER BUILDING CONST. NEW ADD/ALTER

SEWAGE DISPOSAL SYSTEM CONTRACTOR: _____ TEL: _____
 ADDRESS: _____
 GENERAL CONTRACTOR: _____

NO. OF TOTAL NO. OF BEDROOMS: 3 WATER SUPPLY: PUBLIC PRIVATE W LOT SIZE: 19.4 Acres

APPLICANT AGREES THAT:
 1. HEALTH DEPARTMENT ENVIRONMENTAL HEALTH SPECIALIST WILL BE NOTIFIED A MINIMUM OF 24 HOURS PRIOR TO COMMENCING WORK.
 2. HEALTH DEPARTMENT ENVIRONMENTAL HEALTH SPECIALIST AND ENGINEERS OR CONSULTING ENVIRONMENTAL HEALTH SPECIALISTS' INSPECTION, WHEN INDICATED, WILL BE OBTAINED PRIOR TO COVERING THE SYSTEM.
 3. THE JOB CARD AND A COPY OF THE APPROVED SEWAGE DISPOSAL SYSTEM DESIGN SHALL BE AVAILABLE AT THE JOB SITE AT ALL TIMES.
 4. ANY DEVIATION FROM APPROVED PLAN WITHOUT PRIOR APPROVAL OF THE HEALTH OFFICER WILL BE CAUSE FOR STOPPING WORK UNTIL THE CHANGES ARE FULLY JUSTIFIED AND APPROVED.
 5. THE SEPTIC TANK MUST BE I.A.P.M.O. APPROVED.
 6. PRIOR TO AUTHORIZING OCCUPANCY OF ANY BUILDING WITH AN ENGINEER OR CONSULTING ENVIRONMENTAL HEALTH SPECIALIST DESIGNED SYSTEM, A SIGNED STATEMENT BY THE DESIGNER CERTIFYING THAT THE SYSTEM WAS INSTALLED IN COMPLIANCE WITH THE APPROVED PLAN MUST BE SUBMITTED TO THE PUBLIC HEALTH OFFICER.
 7. THIS PERMIT IS SUBJECT TO REVOCATION IF FOUND TO BE IN NONCONFORMANCE WITH SONOMA COUNTY CODE OR STANDARDS OF THE PUBLIC HEALTH DEPARTMENT.
 8. THIS PERMIT IS NOT TRANSFERABLE.

IT IS UNDERSTOOD THAT THE ISSUANCE OF A PERMIT IN NO WAY INDICATES THAT A GUARANTEE OF PERFECT AND INDEFINITE OPERATION OF THIS SYSTEM IS MADE BY THE COUNTY OF SONOMA PUBLIC HEALTH DEPARTMENT AND THAT THE OWNER IS REQUIRED TO MAKE ANY REPAIRS NECESSARY TO MAINTAIN THE SURFACE OF THE GROUND. APPROVAL IS BASED UPON INFORMATION SUBMITTED BY THE APPLICANT. FIELD CONDITIONS AT VARIANCE WITH APPLICATION MAY VOID PERMIT.

I HEREBY ACKNOWLEDGE THAT I HAVE READ THIS APPLICATION AND THE INSTRUCTIONS ON THE REVERSE SIDE AND STATE THAT THE ABOVE IS CORRECT AND AGREE TO COMPLY WITH ALL COUNTY ORDINANCES AND STATE LAWS REGULATING CONSTRUCTION OF PRIVATE SEWAGE DISPOSAL SYSTEMS. THIS PERMIT SHALL EXPIRE BY LIMITATION OF WORK AUTHORIZED IS NOT COMMENCED WITHIN 180 DAYS.

SIGNATURE OF APPLICANT: Sander A. Torgerson

CONTRACTOR'S LICENSE CERTIFICATE
 (COMPLETE EITHER A OR B)
 A. THE APPLICANT IS LICENSED UNDER THE PROVISIONS OF THE CONTRACTORS LICENSE LAW UNDER LICENSE NUMBER: _____ BY _____

WORKMEN'S COMPENSATION CERTIFICATE
 (One or two must be completed)
 1. A currently effective certificate of Workmen's Compensation Insurance coverage is on file with the Sonoma County Public Health Department.
 2. I certify that in the performance of the work for which this permit is issued, I shall not employ any person in any manner so as to become subject to the provisions of the Compensation Insurance Law of California.

WHICH LICENSE IS IN FULL FORCE AND EFFECT:
 A. THE APPLICANT IS EXEMPT FROM THE PROVISIONS OF THE CONTRACTORS LICENSE LAW FOR THE FOLLOWING REASONS:
 1) OWNER/BUILDER
 2) OTHER (EXPLAIN) _____

APPLICANT'S SIGNATURE: Sander A. Torgerson DATE: 9/28/95

CONSTRUCTION APPROVED BY: David Johnson DATE: 10/3/95

001342D	SEP TANK	241.00
TLTANT	CHECKS	241.00
CHANCE	CHANCE	0.00
718B #2		9:12

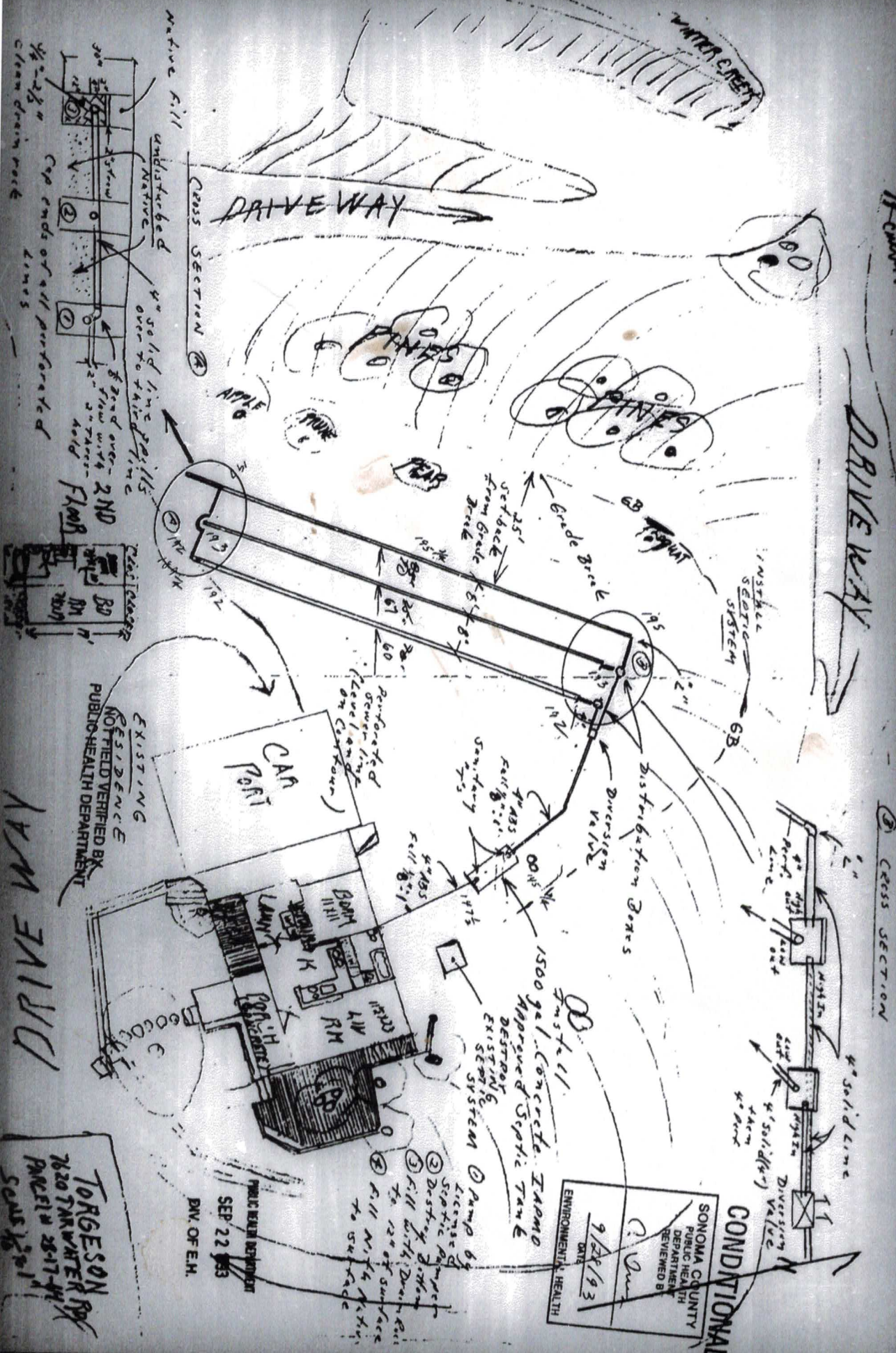

Native fill undisturbed
 4" solid line pipe
 over to fair pipe
 8" sand over 2ND FLOOR
 2" sand over 1st FLOOR
 1/2" x 1/2" clean drain pipe
 Cap ends of all perforated lines

EXISTING NOT FIELD VERIFIED BY PUBLIC HEALTH DEPARTMENT

DRIVEWAY

TORGESSON PO
 7620 TARKWATER RD
 PUNCELO 25-17-91
 SANS 1/2/91

PUBLIC HEALTH DEPARTMENT
 SEP 22 1993
 DW. OF E.H.

- 1) Pump by license
- 2) Septic Tank
- 3) Destroying old system
- 4) Fill with 1/2" drain pipe to 12" of surface
- 5) Fill with 1/2" drain pipe to surface

SONOMA COUNTY
 PUBLIC HEALTH
 DEPARTMENT
 REVIEWED BY
 R. Qu
 9/20/93
 ENVIRONMENTAL HEALTH

CONDITIONAL

IF CANNOT

DRIVEWAY

CROSS SECTION



**COUNTY OF SONOMA
PUBLIC HEALTH DEPARTMENT
ENVIRONMENTAL HEALTH SERVICES**

MARK A. KOSTIENEY
Director of Public Health
GEORGE R. FLORES, M.D.
Health Officer

1030 CENTER DRIVE, SUITE A • SANTA ROSA • CALIFORNIA 95403-2067 • TELEPHONE (707) 525-6500

CONDITIONAL PRIVATE SEWAGE DISPOSAL REPAIR PERMIT

REVIEW THE FOLLOWING CONDITIONS PRIOR TO PERMIT ISSUANCE

NAME: SANDER A TORGEBSON
ADDRESS: 7620 TARWATER RD.
CITY: SANTA ROSA CA 95404
PERMIT NO: S 93 - 0856 LK

CONDITION(S):

The proposed septic system repair does not meet current Sonoma County Public Health Department criteria. Inspection of the repair by this department will be to check proper installation only.

The sewage disposal system is considered non-conforming due to the following reasons. There may be other site limitations that are not apparent at this time.

- Soils evaluations ~~and/or groundwater determinations~~ have not been conducted. Soil ~~and groundwater~~ conditions may impact proper septic system operation, ~~particularly during wet-weather conditions.~~
- The size of the leachfield appears smaller than typical for this size house or for soil types in the area.
- A standard septic system design appears poorly suited for the site. An alternative design would be preferable.
- The installation does not conform to present code setbacks.
- Other: _____

Bedroom additions, substantial remodeling or reconstruction cannot be approved unless the septic system can be brought into compliance with present Sonoma County Public Health Department reutilization criteria. The issuance of this permit does not constitute a recognition by the County of the legality of any structures on the parcel.

The Sonoma County Public Health Department has authorized this repair to allow continued occupancy of this existing structure and in no way implies any guarantee of the work proposed or of the function, effectiveness or longevity of this repair. The use of low-flow toilets and other water conservation measures are strongly recommended to decrease sewage flow to the septic system.

I understand and accept these conditions:

Signed: Sander A. Torgeson
Date: 10/2/93

Sonoma County Public Health Department
Environmental Health Division
1030 Center Drive - Suite A
Santa Rosa, CA 95402

SEPTIC SYSTEM INSPECTION

Site Address: 2670 Terwater

Owner: Torgeson

REQUEST FOR INSPECTION

Date of call: _____ Time: _____

Caller: _____

Phone No. of caller: _____

Remarks: _____

Call taken by: _____

INSPECTION NOTICE

Stop work immediately-Call Sanitarian
Telephone: _____ Hours: _____

- OK to cover leachfield 4/1 tank No 1
- Provide Engineer's letter of approval
- Provide "As Built" plan to scale
- Call for inspection on pump and alarm
- Corrections needed, see "Remarks"
- OK to cover with Engineer's OI
- Issue Operational Permit

For further information call: _____

Hours and Day: _____

Remarks:
Tank has no fall
Remove caulder couple
at tank.
Grout 5' ABS sections
to tank with 1" fall
Make sure you have
2" fall between inlet
& outlet.

Destroy septic tanks
as noted

Signature: C. Inea 10/25/1995
Sanitarian Date

Received: [Signature]
 Photos show pictures

Dist: White-E.H. Yellow-Job site Pink-Plans etc
11/20/95

Permit History Lookup

This service provides convenient access to permit history information. All reasonable effort has been made to ensure the accuracy of the data provided. However, the data may be out of date or inaccurate. The County of Sonoma assumes no responsibility arising from the use of this information. This information and associated data are provided without warranty of any kind, either expressed or implied, including but not limited to, the implied warranties of merchantability and fitness for a particular purpose. Do not make any business decisions based on this data before validating the data with the Sonoma County Permit and Resource Management Department.

Permit History By Address

Address:

7620 Tarwater Rd

PRMD Area:

Rincon Valley

Permits:

14

Permit History as of March 26, 2015

Number	Date	Status	Type	Description	Scanned
VBU98-0496	10/8/1998	Fileclsd	VIO-BLDG	COMPLETE REPLACEMENT OF BRIDGE ON TARWATER RD	
B-142378	5/15/1997	Issued	B-BLD	ADD/REMODEL TO SFD	
B-142060	4/28/1997	Issued	AB-DEM	DEMOLITION - PARTIAL DEMOLITION OF SFD	Yes
SEP93-1275	9/10/1993	Issued	OLD-WSEP	Repair - SDS - Voluntary Conditional Statement. Expired letter 1-24-95.	
B-113551	6/18/1992	Finaled	OLD-BLDG	ELEC METER	
B-113552	6/18/1992	Finaled	OLD-BLDG	ELEC UPGRADE	
B-113553	6/18/1992	Finaled	OLD-BLDG	ELEC METER	
B-079626	8/6/1987	Finaled	OLD-BLDG	ADDN	
PX013607	5/12/1987	Finaled	OLD-BLDG	SUN ROOM/STORE	
098629-B	9/10/1986	Finaled	OLD-BLDG	BUILDING W/O PE	
B-065104	5/9/1985	Expired	OLD-BLDG	ELEC	
D-008584	11/16/1984	Finaled	OLD-BLDG	AG EXEMPT	Yes
B-062931	11/9/1984	Finaled	OLD-BLDG	SITE REVIEW	
B-049362	12/28/1981	Finaled	OLD-BLDG	SOLAR DHW	Yes
Number	Date	Status	Type	Description	Scanned

Important Notes

- ◆ The Permit History provided may not include all records for this property. Further investigation may be required to obtain a more complete history, due to: address changes, parcel mergers, splits, retirements, etc.
- ◆ Date(s) listed in this report reflect the earliest known date(s) associated with each file. The date(s) listed are not associated with the current status.
- ◆ Permit Status Definitions (PDF: 57 kB) have been modified through time, to better identify milestones during the life span of a specific File Type. Many historical files reflect statuses which are no longer in use.
- ◆ Although every effort is made to provide complete and accurate information on this website, visitors are advised to contact appropriate Permit and Resource Management Department (PRMD) staff before making project decisions. This may involve contacting more than one section within PRMD (Building, Plan Check, Zoning, Well & Septic, etc.), since each section implements specific codes or ordinances which may affect your project.

Mike Treinen Consulting

Escrow Inspections * Design * Consultation

Mike Treinen, R.E.H.S.

526-0872 Phone & Fax

treinen@sonic.net



Services:

- ◆ Inspections
 - Escrow or Pre-Escrow
 - Buyer or Seller
 - Homeowner
- ◆ Design
 - Standard Systems
 - Repairs
- ◆ General Consultation
- ◆ Home Remodel Issues
- ◆ Expert Witness Work

Experience:

- ◆ Former Sonoma County Well & Septic Division Supervisor
- ◆ California Registered Environmental Health Specialist
- ◆ NAWT Accredited Inspector & Instructor
- ◆ Over 30 years of Experience with Onsite Wastewater
- ◆ SRJC Septic System Classes – 20 Years
- ◆ Education Committee Member – California Onsite Wastewater Association (COWA)
- ◆ Past Chair: Sonoma County Land Use Advisory Panel, County Project Review Advisory and Environmental Review Committees
- ◆ Work on State Septic System Assembly Bill 885 Draft Environmental Impact Report