

# Permit Sonoma: Zoning & Land Use



10/8/2020, 11:43:11 AM

Parcel

Base Zoning

Source: Esri, Maxar, GeoEye, Earthstar Geographics, CNES/Airbus DS,

Sonoma County Vegetation Mapping and LiDAR Consortium, NASA, University of Maryland, Watershed Sciences, Inc., Tukman Geospatial LLC | PLEASE READ CAREFULLY ACCESS AND USE CONSTRAINTS. PRMD REQUESTS YOUR FULL PARTICIPATION

Permit Sonoma

# Permit Sonoma: Zoning & Land Use

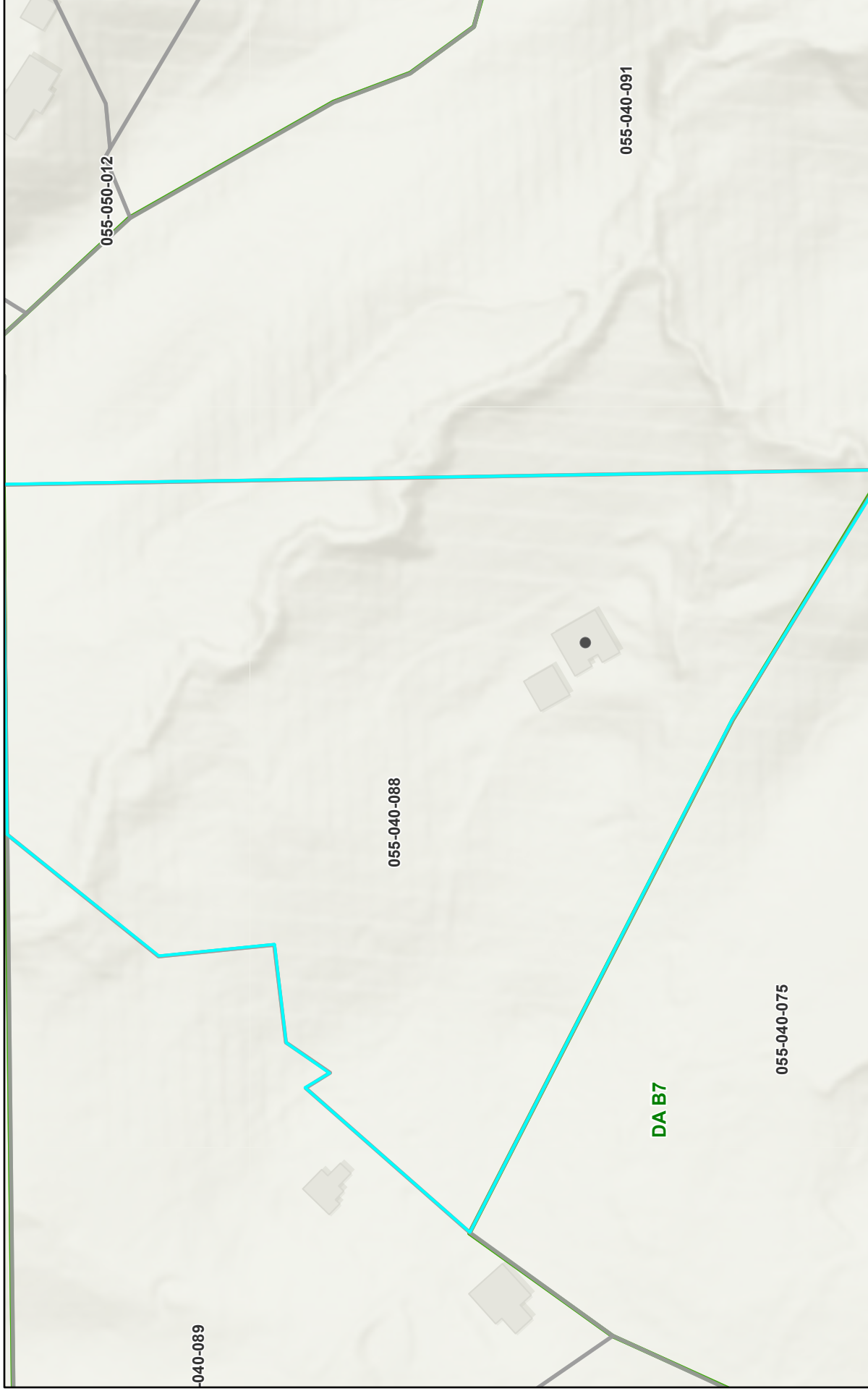

10/8/2020, 11:45:32 AM

Parcel

Base Zoning

1:2,257

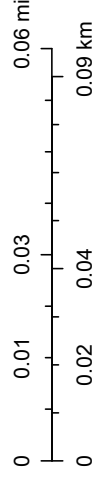

Sources: Esri, Airbus DS, USGS, NGA, NASA, CGIAR, N Robinson, NCEAS,



## Permit History Lookup

This service provides convenient access to permit history information for properties located within unincorporated Sonoma County. You can search by assessor parcel number or by street address.

For help understanding what the permit numbers mean, visit our [Permit Numbering Information](#) page.

### Important Disclaimers

All reasonable effort has been made to ensure the accuracy of the data provided. However, some of the data may be out of date or inaccurate.

The County of Sonoma assumes no responsibility arising from the use of this information. This information and associated data are provided without warranty of any kind, either expressed or implied, including but not limited to, the implied warranties of merchantability and fitness for a particular purpose. Do not make any business or financial decisions based on this data before validating the data with Permit Sonoma.

## Results

**Address:** 5820 Enterprise Rd, Glen Ellen

**Permits:** 13

### Permit History as of October 08, 2020

Number	Date	Status	Type	Description	Scanned
BLD19-6810	11/5/2019	Finald	Building Permit No Plan Check	ELEC SRV UPGRADE 100AMPS FOR SFD ON PUMP HOUSE	Yes
BLD18-7799	12/26/2018	Issued	Building Permit No Plan Check	FOR SFD - FURNACE REPLACEMENT ONLY - AFUE 80%	No
R/S 09-132	12/10/2009	Map Approved	Record of Survey	SKINNER/PEARLMAN --- MAP FILED AT COUNTY RECORDER IN BOOK 737 MAPS 36, SONOMA COUNTY RECORDS	
B-147230	4/13/1998	Finald	Building Permit With Plan Check	BUILD GUNITE SWIM POOL PER STOCK PLAN	
SEP98-0352	4/13/1998	Closed	Septic Permit	POOL CLEARANCE ROUTED TO HARD FILE 4/13/98	Yes
WEL91-0274	6/6/1991	Finald	Well And Septic History Record	Water Well Out of water	
B-093898	6/26/1989	Finald	Building History Record	RPR FOUNDATION	
PX018466	3/23/1989	INERT	Building History Record	RPR FOUNDATION	
T-010333	9/27/1979	Finald	Building History Record	TEMP ELEC	
B-037424	7/3/1979	Finald	Building History Record	FDN ONLY	
S-031940	7/3/1979	Finald	Building History Record	NEW SYS	

Number	Date	Status	Type	Description	Scanned
T-009958	4/11/1979	Expired	Building History Record	TEMP ELEC	
B-038197	3/6/1979	Finald	Building History Record	NEW SFD	

## Important Notes

- The Permit History provided may not include all records for this property. Further investigation may be required to obtain a more complete history due to: address changes, parcel mergers, splits, retirements, etc.
- Date(s) listed in this report reflect the earliest known date(s) associated with each file. The date(s) listed are not associated with the current status.
- Permit Status Definitions have been modified through time to better identify milestones during the life span of a specific File Type. Many historical files reflect statuses which are no longer in use.
- Although every reasonable effort is made to provide complete and accurate information on this website, visitors are advised to contact appropriate Permit Sonoma staff before making project decisions. This may involve contacting more than one section within Permit Sonoma (Building Inspection, Plan Check, Planning (Zoning), Well & Septic, etc.) since each section implements specific codes or ordinances which may affect your project.

## Glossary of Table Header Terms

### Number

The number of the permit or record. For help understanding what the permit numbers mean, visit our [Permit Numbering Information](#) page.

### Date

Date(s) listed in this report reflect the earliest known date(s) associated with each file. The date(s) listed are not necessarily associated with the current status.

### Status

The current status of the permit or record. Permit status definitions have been modified through time to better identify milestones during the life span of a specific permit or record. Many historical files reflect statuses which are no longer in use.

### Type

The type of permit or record. For more information on the types of permits, visit our [Permit Numbering Information](#) page.

### Description

A manually-entered description of the project associated with a specific permit or record. Some older permits and records have descriptions that are not very descriptive due to the space limitations of older permitting software at the time the record was created.

### Scanned

Denotes whether or not supporting materials have been electronically scanned.

## Page Links

1. Permit Numbering Information - <https://sonomacounty.ca.gov/PRMD/Services/Permit-History-Lookup//PRMD/Permit-Numbering-Information/>



# COUNTY OF SONOMA

## Permit History Lookup

This service provides convenient access to permit history information for properties located within unincorporated Sonoma County. You can search by assessor parcel number or by street address.

For help understanding what the permit numbers mean, visit our [Permit Numbering Information](#) page.

### Important Disclaimers

All reasonable effort has been made to ensure the accuracy of the data provided. However, some of the data may be out of date or inaccurate.

The County of Sonoma assumes no responsibility arising from the use of this information. This information and associated data are provided without warranty of any kind, either expressed or implied, including but not limited to, the implied warranties of merchantability and fitness for a particular purpose. Do not make any business or financial decisions based on this data before validating the data with Permit Sonoma.

## Results

Parcel Number: 055-040-088

Permits: 6

### Permit History as of October 08, 2020

Number	Date	Status	Type	Description	Scanned
BLD19-6810	11/5/2019	Finalized	Building Permit No Plan Check	ELEC SRV UPGRADE 100AMPS FOR SFD ON PUMP HOUSE	Yes
BLD18-7799	12/26/2018	Issued	Building Permit No Plan Check	FOR SFD - FURNACE REPLACEMENT ONLY - AFUE 80%	No
R/S 09-132	12/10/2009	Map Approved	Record of Survey	SKINNER/PEARLMAN --- MAP FILED AT COUNTY RECORDER IN BOOK 737 MAPS 36, SONOMA COUNTY RECORDS	
B-147230	4/13/1998	Finalized	Building Permit With Plan Check	BUILD GUNITE SWIM POOL PER STOCK PLAN	
SEP98-0352	4/13/1998	Closed	Septic Permit	POOL CLEARANCE ROUTED TO HARD FILE 4/13/98	Yes
WEL91-0274	6/6/1991	Finalized	Well And Septic History Record	Water Well Out of water	

## Important Notes

- The Permit History provided may not include all records for this property. Further investigation may be required to obtain a more complete history due to: address changes, parcel mergers, splits, retirements, etc.
- Date(s) listed in this report reflect the earliest known date(s) associated with each file. The date(s) listed are not associated with the current status.
- Permit Status Definitions have been modified through time to better identify milestones during the life span of a specific File Type. Many historical files reflect statuses which are no longer in use.

- Although every reasonable effort is made to provide complete and accurate information on this website, visitors are advised to contact appropriate Permit Sonoma staff before making project decisions. This may involve contacting more than one section within Permit Sonoma (Building Inspection, Plan Check, Planning (Zoning), Well & Septic, etc.) since each section implements specific codes or ordinances which may affect your project.

## Glossary of Table Header Terms

### Number

The number of the permit or record. For help understanding what the permit numbers mean, visit our [Permit Numbering Information](#) page.

### Date

Date(s) listed in this report reflect the earliest known date(s) associated with each file. The date(s) listed are not necessarily associated with the current status.

### Status

The current status of the permit or record. Permit status definitions have been modified through time to better identify milestones during the life span of a specific permit or record. Many historical files reflect statuses which are no longer in use.

### Type

The type of permit or record. For more information on the types of permits, visit our [Permit Numbering Information](#) page.

### Description

A manually-entered description of the project associated with a specific permit or record. Some older permits and records have descriptions that are not very descriptive due to the space limitations of older permitting software at the time the record was created.

### Scanned

Denotes whether or not supporting materials have been electronically scanned.

## Page Links

1. Permit Numbering Information - <https://sonomacounty.ca.gov/PRMD/Services/Permit-History-Lookup//PRMD/Permit-Numbering-Information/>



# COUNTY OF SONOMA

## Zoning & Parcel Report

Zoning and Land Use information for unincorporated Sonoma County. Find out important information about your parcel. Some examples of parcel information:

Jurisdiction (unincorporated Sonoma County or incorporated city).

Zoning and Land Use codes, Groundwater Availability, Supervisorial District, Williamson Act Land Contract, etc. (unincorporated areas only).

[Explanation of the Zoning Codes »](#)

Find out what the different zoning letter and number codes mean (e.g. RR, R1, C3, CC).

[Find My Assessor Parcel Number »](#)

### Results

**Parcel Number:** 055-040-088

**Jurisdiction:** Unincorporated Sonoma County

**Zoning:** DA B6 20, RC50/50 SR VOH  
[What the Zoning Codes Mean](#)

**Land Use:** DA 20

**Air Quality Control Board:** Bay Area Air Quality Management District

**ALUC Referral Area:** Not Applicable

**Area & Specific Plan:** Bennett Valley Area Plan

**Assessor Notes:** From 055-040-69

**Assessor Tax Rate Area (TRA):** 158002

**Assessor Use Code:** 0052 [Rural Res/2 Or More Res]

**Bodega Bay PUD:** Not Applicable

**California Tiger Salamander:** Not Applicable

**Fire District:** Glen Ellen FPD

**Fire Protection Response Area:** SRA = State

**Flood Prone Urban Area:** Not Applicable

**Groundwater Availability:** Zone 3 - Marginal groundwater

**Inspector - Building:** Rick Behrens

**Inspector - Code Enforcement:** Scott Lapinski

**Inspector - Well & Septic:** Southeast District

**Inspector - Well & Septic, Plan Review:** Southeast District

**Land Size - Acres:** 10

**Land Size - SqFt:** 0

**Landslide:** Few Landslides, Surficial Deposits

**Lat/Long (Parcel Center):** 38.382145, -122.561971

**Liquefaction:** Very Low Susceptibility

**Local Area Development Guideline:** Not Applicable

**NRCS Soils (Expansive Soils\*):** CcB\*, GgF, SkD

<b>Parcel Specific Policy:</b>	PA TBL 20 [Entire Parcel]
<b>Planning Area:</b>	9 - Sonoma Valley
<b>Redevelopment Plan:</b>	Not Applicable
<b>Sanitation District:</b>	Not Applicable
<b>School District - Elementary:</b>	Sonoma Valley
<b>School District - High:</b>	Sonoma Valley
<b>Seismic Design Category (SDC):</b>	SDC D
<b>Sphere of Influence:</b>	Not Applicable
<b>Supervisory District:</b>	District 1
<b>Urban Growth:</b>	Not Applicable
<b>Urban Service Area:</b>	Not Applicable
<b>Waiver Prohibition Area:</b>	Not Applicable
<b>Water Quality Control Board:</b>	San Francisco Bay Region
<b>Wet Weather Zone:</b>	C - Santa Rosa
<b>Williamson Act Land Contract:</b>	Not Applicable



#### Contact Information

##### Planning Division

Permit & Resource Management  
Department  
County of Sonoma

Contact Planning Division

Email: [Planner@sonoma-county.org](mailto:Planner@sonoma-county.org)

##### Contact Planning by Phone

Monday – Friday

10:00 AM – 12:00 PM

1:00 PM – 3:00 PM

Phone: (707) 565-1900, option 5

CA Relay Service: 711

##### Address

2550 Ventura Avenue  
Santa Rosa, CA 95403

## Page Links

1. Explanation of the Zoning Codes - <https://sonomacounty.ca.gov/PRMD/Services/Zoning-and-Parcel-Report//PRMD/Services/Zoning-and-Parcel-Report/Zoning-Codes/>
2. Find My Assessor Parcel Number - <https://sonomacounty.ca.gov/PRMD/Services/Zoning-and-Parcel-Report//PRMD/Planning/FAQs-Zoning/#find-apn>
3. What the Zoning Codes Mean - [http://sonomacounty.ca.gov/\\_templates\\_portal/Page.aspx?id=2147539257](http://sonomacounty.ca.gov/_templates_portal/Page.aspx?id=2147539257)
4. Contact Planning Division - <https://sonomacounty.ca.gov/PRMD/Services/Zoning-and-Parcel-Report//PRMD/Planning/Contact-Us/>



Article 08. - DA Diverse Agriculture District.

Sec. 26-08-005. - Purpose.

Purpose: to enhance and protect those land areas where soil, climate and water conditions support farming but where small acreage intensive farming and part-time farming activities are predominant, but where farming may not be the principal occupation of the farmer; and to implement the provisions of the diverse agriculture land use category of the General Plan and the policies of the Agricultural Resource Element.

(Ord. No. 5964, § V, 1-31-2012; Ord. No. 4643, 1993.)

Sec. 26-08-010. - Permitted uses.

Permitted uses include the following:

- (a) On parcels exceeding two (2) acres, raising, feeding, maintaining and breeding of farm animals. When such farming involves animals which are continuously confined, such as veal calves, poultry, hogs and pigs, dairy cows or similar livestock which may result in concentrations of animal waste, the use shall be subject to issuance of a zoning permit based upon written approval of the Sonoma County Health Services Department and the applicable regional water quality control board of a confined animal management plan. Horses, goats, sheep, and similar farm animals are not considered to be confined animals for purposes of this chapter. The plan shall include provisions for:

- (1) Containment of waste to the site,
- (2) Reuse or disposal of waste in accordance with health and/or water quality regulations,
- (3) Mitigation of potential water quality impacts due to surface runoff of waste,
- (4) Control of vectors.

In the event that the confined animal use is proposed within five hundred feet (500') of a nonagricultural land use category, it shall require prior approval of a use permit;

- (b) On parcels of two (2) acres or less, raising, feeding, maintaining and breeding of not more than one (1) of the following per twenty thousand (20,000) square feet of area:
- (1) Five (5) hogs or pigs,
  - (2) One (1) horse, mule, cow or steer,
  - (3) Five (5) goats, sheep, or similar animals,
  - (4) Fifty (50) chickens or similar fowl,
  - (5) Fifty (50) ducks or geese or one hundred (100) rabbits or similar animals,
  - (6) The above limitations may be modified by the planning director upon submittal of a proposal statement which describes the extent of the domestic farming use and which is signed by the owners of all property within three hundred feet (300') of the subject property. The planning director may require the applicant to obtain a use permit if the director determines that the project might be detrimental to surrounding uses,
  - (7) 4-H and FFA animal husbandry projects are permitted without limitation of parcel size; provided, that the parcel contains at least twenty thousand (20,000) square feet and provided further, a letter of project authorization is first submitted by the project advisor. The planning director may require the applicant to obtain a use permit when the director determines that the project might be detrimental to surrounding uses;

- (c) Beekeeping;
- (d) Outdoor crop production including wholesale nurseries, for growing and harvesting of shrubs, plants, flowers, trees, vines, industrial hemp, fruits, vegetables, hay, grain and similar food and fiber crops other than cannabis, conducted and maintained in compliance with Article 65, RC Riparian Corridor Combining Zone;
- (e) Agricultural support services involving no more than one (1) employee and occupying no more than one-half (½) acre of land and subject, at a minimum to the criteria of General Plan Policies AR-5e and AR-5f. Such services may include incidental sales of products related to the support service use but shall not include additional walk-in, over-the-counter retail sales.

The following factors shall be considered in determining an agricultural support service to be "clearly subordinate to on-site agricultural production" as provided in above Policy AR-5e:

- (1) The geographic area of the lot devoted to the support service use in comparison to that remaining in agricultural production,
- (2) Whether or not new structures or significant expansion of existing structures are needed to accommodate the support service use,
- (3) The relative number of employees devoted to the support service use in comparison to that needed for agricultural production,
- (4) Any such use on a parcel under a Williamson Act contract must be consistent with Government Code Section 51200 et seq. (the Williamson Act) and local rules and regulations;
- (f) Incidental cleaning, grading, packing, polishing, sizing, storage and similar preparation of crops which are grown on the site, but not including agricultural processing;
- (g) (1) Farm stand for the temporary or seasonal sales and promotion of crops grown or animals raised on the site including community supported agriculture, U-Pick and U-Cut operations.
- (2) Farm retail sales facility subject to issuance of a zoning permit and compliance with Section 26-88-215;
- (h) Residential uses include the following:
  - (1) Single-family detached dwelling unit(s) in accordance with the residential density permitted by the General Plan land use element or permitted by a "B" combining district, whichever is more restrictive. These unit(s) may be manufactured homes, but only one (1) may be a manufactured home without a permanent foundation,

A manufactured home without a permanent foundation shall require prior approval of a zoning permit notice of which shall be posted at least ten (10) days prior to issuance, during which an appeal may be filed and processed pursuant to Section 26-92-040.

Issuance of the zoning permit shall be subject, at a minimum, to the following conditions:

- (i) The manufactured home shall be at least twelve feet (12') in width except those that are owned and occupied on the effective date of the ordinance codified in this chapter,
- (ii) The manufactured home shall be skirted. All skirting shall be of a type approved by the state of California,
- (iii) The manufactured home shall have one (1) patio awning with a minimum dimension of nine feet (9') by twenty feet (20') and either a garage, carport, or awning with a minimum dimension of ten feet (10') by twenty feet (20') for covered parking,
- (iv) All manufactured home sites shall be landscaped,
- (v) The manufactured home shall be occupied by the owner of the property or a relative of the owner;

- (2) One (1) dwelling unit for full-time agricultural employees for each of the following agricultural uses conducted on the site:
- (i) At least fifty (50) mature dairy cows, dairy sheep, or dairy goats
  - (ii) At least twenty (20) acres of grapes, apples, pears, prunes,
  - (iii) At least twenty thousand (20,000) broilers, fifteen thousand (15,000) egg-layers or three thousand (3,000) turkeys,
  - (iv) At least one hundred (100) non-dairy sheep, goats, beef cattle, replacement heifers, or hogs,
  - (v) At least thirty (30) mature horses,
  - (vi) Wholesale nurseries with a minimum of either one (1) acre of propagating greenhouse or outdoor containers or three (3) acres of field-grown plant materials,
  - (vii) Any other agricultural use which the planning director determines to be of the same approximate agricultural value and intensity as Subsections (h)(3)(i) through (vi) of this section;

The dwelling unit(s) may be conventionally built homes or manufactured homes (with or without permanent foundations), provided that manufactured homes without a permanent foundation shall require a zoning permit approved in the manner described in subsection (h)(1) of this section. Agricultural employee units may be established within designated Class 4 water-scarce areas only where a hydrogeology report, as defined, certifies that the establishment and continuation of the additional residential use will not have significant adverse impacts on local or cumulative groundwater availability or yield.

Prior to the issuance of building or zoning permits for the employee unit(s), the property owner shall place on file with the planning department an affidavit that the unit(s) will be used to house persons employed on the premises for agricultural purposes. Further, a covenant shall be recorded, in a form satisfactory to county counsel, which acknowledges that in the event that the agricultural use is terminated on the property, the agricultural employee dwelling shall become a nonconforming residential use,

- (3) Temporary farm worker camps consisting of up to four (4) self-contained recreational vehicles and/or travel trailers to house persons solely employed on the site for agricultural purposes for less than ninety (90) days, subject to the following:
- The property owner must submit a written affidavit to the planning department, stating that the recreational vehicle and/or travel trailer will only be used to house persons solely employed on the site of a bona fide agricultural enterprise. The camp shall be subject to applicable septic regulations. The recreational vehicle or trailer shall be immediately removed from the site when it is no longer occupied by persons who are solely employed on the premises site,
- (4) Seasonal farmworker housing which meets the standards set forth in Section 26-88-010(l). Seasonal farmworker housing shall also conform to such public health, building and fire safety criteria as may be established by resolution or ordinance of the Board of Supervisors,
- (5) Year-round and extended seasonal farmworker housing which meets the standards set forth in Section 26-88-010(o). Year-round and extended seasonal farmworker housing shall also conform to such public health, building, and fire safety criteria as may be established by resolution or ordinance of the Board of Supervisors,
- (6) One caretaker unit for properties with seasonal farmworker housing, subject to the provisions of Section 26-88-010 (l)(8),
- (7) One (1) guest house per lot,

- (8) One (1) travel trailer per lot for use as temporary housing in accordance with Section 26-88-010(q) and provided that a travel trailer administrative permit is obtained and renewed annually,
  - (9) One (1) accessory dwelling unit per lot, pursuant to Section 26-88-060. Accessory dwelling units are not permitted on land subject to a Williamson Act contract;
  - (10) One junior accessory dwelling unit per lot, pursuant to Section 26-88-061.
- (i) The following nonagricultural uses; provided, that the applicant must demonstrate that the use meets a local need, avoids conflict with agricultural activities and is consistent with Objective AR-4.1 and Policy AR-4a of the Agricultural Resources Element:
- (1) Boarding and training of horses subject to issuance of a zoning permit. Any such use on a parcel under a Williamson Act contract must be consistent with Government Code Section 51200 et seq. (the Williamson Act) and local rules and regulations,
  - (2) Home occupations subject to the requirements of Section 26-88-121 and approval of a zoning permit. Any home occupation use on a parcel under a Williamson Act contract must be consistent with Government Code Section 51200 et seq. (the Williamson Act) and local rules and regulations,
  - (3) Small residential community care facilities, except on land subject to a Williamson Act contract,
  - (4) Occasional cultural events, provided that a written notice stating "The Sonoma County Planning Department will issue a zoning permit for a cultural event (state nature and duration) on this property if a written appeal is not received within ten (10) days from the date of this notice." is posted on the property at least ten (10) days prior to issuance of a zoning permit, and no appeal pursuant to Section 26-92-040 has been received from any interested person, and provided that approval is secured from the following departments: sheriff, public health, fire services, building inspection and public works. In the event of an appeal, a hearing on the project shall be held pursuant to Section 26-92-040. Any such use on a parcel under a Williamson Act contract must be consistent with Government Code Section 51200 et seq. (the Williamson Act) and local rules and regulations,
  - (5) Management of land for watershed, for fish and wildlife habitat, fish rearing ponds, hunting and fishing, where these uses are incidental to the primary use,
  - (6) Small family day care. Any such use on a parcel under a Williamson Act contract must be consistent with Government Code Section 51200 et seq. (the Williamson Act) and local rules and regulations,
  - (7) Large family day care, provided that the applicant shall meet all performance standards listed in Section 26-88-080, except on land subject to a Williamson Act contract;
  - (8) Pet fancier facilities, provided that a pet fancier license is obtained from the division of animal regulation and renewed annually. Any such use on a parcel under a Williamson Act contract must be consistent with Government Code Section 51200 et seq. (the Williamson Act) and local rules and regulations,
  - (9) Public parks,
  - (10) Craft sales and garage sales not exceeding two (2) sales days per calendar year, provided that prior notification is given to the California Highway Patrol and that adequate off-street parking is provided,
  - (11) Attached commercial telecommunication facilities subject to the applicable criteria set forth in Section 26-88-130,
  - (12) Minor freestanding commercial telecommunication facilities, subject to the applicable criteria set forth in Section 26-88-130, and subject to approval of a zoning permit, including environmental review, for which notice, including a site plan and one (1) elevation with

dimensions for such facility, is mailed to adjacent property owners and posted on the subject property at least ten (10) days prior to issuance of the permit and provided that no appeal pursuant to Section 26-92-040 has been received from any interested person. In the event of an appeal, a hearing on the project shall be held pursuant to the above section. Any such use on a parcel under a Williamson Act contract must be consistent with Government Code Section 51200 et seq. (the Williamson Act) and local rules and regulations,

- (13) Noncommercial telecommunication facilities eighty feet (80') or less in height subject to the applicable criteria set forth in Section 26-88-130. Facilities between forty feet (40') and eighty feet (80') in height are subject to approval of a ministerial zoning permit for which notice is mailed to adjacent property owners and posted on the subject property at least ten (10) days prior to issuance of the permit and provided that no appeal pursuant to Section 26-92-040 has been received from any interested person. In the event of an appeal, a hearing on the project shall be held pursuant to the above section,
- (14) Small wind energy systems not located within a county-designated urban service area or within two thousand five hundred feet (2,500') of a county-designated urban service area, subject to zoning permit approval and the standards in Section 26-88-135. Any such use on a parcel under a Williamson Act contract must be consistent with Government Code Section 51200 et seq. (the Williamson Act) and local rules and regulations,
- (15) Agricultural farmstay, subject to issuance of a zoning permit and the standards set forth in Section 26-88-085. Any such use on a parcel under a Williamson Act contract must be consistent with Government Code Section 51200 et seq. (the Williamson Act) and local rules and regulations,
- (16) Non-commercial arts and crafts studios not involving retail or wholesale sales. Any such use on a parcel under a Williamson Act contract must be consistent with Government Code Section 51200 et seq. (the Williamson Act) and local rules and regulations;
- (j) Accessory buildings and uses appurtenant to the operation of the permitted uses. Accessory buildings may be constructed on vacant parcels of two (2) acres or more in advance of a primary permitted use. On vacant parcels less than two (2) acres, accessory buildings may only be constructed if less than one hundred twenty (120) square feet or as incidental to an existing agricultural use. Any such use on a parcel under a Williamson Act contract must be consistent with Government Code Section 51200 et seq. (the Williamson Act) and local rules and regulations;
- (k) Minor timberland conversions, subject to compliance with the requirements of Section 26-88-140;
- (l) Hosted rentals, subject to issuance of a zoning permit and compliance with Section 26-88-118 (Hosted Rentals and Bed and Breakfast Inns);
- (m) Vacation rentals subject to issuance of a zoning permit and conformance with the standards in Section 26-88-120, except on lands under a Williamson Act contract;
- (n) Non-commercial composting when the source materials are obtained primarily onsite and the product is used to amend soils onsite or on adjacent parcels owned or operated by same property owner;
- (o) Other nonresidential uses which in the opinion of the planning director are of a similar and compatible nature to those uses described in this section;
- (p) Small-scale agricultural processing facility subject to issuance of a zoning permit in compliance with Section 26-88-210;
- (q) Cannabis cultivation for personal use in compliance with Section 26-88-258;
- (r) Indoor crop production including wholesale nurseries for growing and harvesting of shrubs, plants, flowers, trees, vines, industrial hemp, fruits, vegetables, hay, grain and similar food and

fiber crops other than cannabis, in greenhouses or similar structures less than two thousand five hundred (2,500) square feet, conducted and maintained in compliance with Article 65, RC Riparian Corridor Combining Zone;

- (s) Commercial cannabis uses in compliance with Section 26-88-250 through 26-88-256;
- (t) Permanent supportive housing, subject to density limitations.

(Ord. No. [6298](#), § III(Exh.), 2-4-2020; Ord. No. [6245](#), § II, 10-16-2018; Ord. No. [6223](#), § VII, 5-8-2018; Ord. No. [6191](#), § V(Exh. D), 1-24-2017; Ord. No. [6189](#), §§ II(B), (G), (I), (J), 12-20-2016; [Ord. No. 6145, § V](#), 3-15-2016; Ord. No. 6089, § I(b), 11-24-2014; Ord. No. 6081, §§ III, IV, 7-29-2014; Ord. No. 5964, § V, 1-31-2012; Ord. No. 5908, § II, 11-9-2010; Ord. No. 5569 § 7, 2005; Ord. 5435 § 2(f), 2003; Ord. No. 5429 § 3(a), 2003; Ord. No. 5361 § 2(c), 2002; Ord. No. 5342 § 4, 2002; Ord. No. 5265 § 1(d), 2001; Ord. No. 5016 § 1(C), 1997; Ord. No. 4985 § 1(b), 1996; Ord. No. 4973 § 3(a), 1996; Ord. No. 4723 § 1(d), 1993; Ord. No. 4653 § 1(e), 1993; Ord. No. 4643, 1993.)

Sec. 26-08-020. - Uses permitted with a use permit.

Uses permitted with a use permit include the following:

- (a) Agricultural cultivation in the following areas, for which a management plan has not been approved pursuant to Section 26-08-010(d):
  - (1) Within one hundred feet (100') from the top of the bank in the Russian River Riparian Corridor,
  - (2) Within fifty feet (50') from the top of the bank in designated flatland riparian corridors,
  - (3) Within twenty-five feet (25') from the top of the bank in designated upland riparian corridors;
- (b) Livestock feed yards, animal sales yards;
- (c) Commercial mushroom farming;
- (d) Commercial stables not permitted under Section 26-04-010(i)(1), riding academies, equestrian riding clubs. Any such use on a parcel under a Williamson Act contract must be consistent with Government Code Section 51200 et seq. (the Williamson Act) and local rules and regulations;
- (e) Commercial aquaculture, provided that, at a minimum, the use does not adversely affect biotic resources and does not take place on prime soils;
- (f) Agricultural support services with more than one (1) employee or occupying more than one half acre of land, but otherwise subject to the same criteria as Section 26-08-010(e). Any such use on a parcel under a Williamson Act contract must be consistent with Government Code Section 51200 et seq. (the Williamson Act) and local rules and regulations;
- (g) Preparation of agricultural products which are not grown on site, processing of agricultural products of a type grown or produced primarily on site or in the local area, storage of agricultural products grown or processed on site, and bottling or canning of agricultural products grown or processed on site, subject, at a minimum, to the criteria of General Plan Policies AR-5c and AR-5g;
- (h) Slaughterhouses, animal processing plants, rendering plants, fertilizer plants or yards which serve agricultural production in the local area and subject, at a minimum, to the criteria of General Plan Policies AR-5c and AR-5g;
- (i) Retail nurseries involving crops/plants which are not grown on the site, except on land subject to a Williamson Act contract;

- (j) Tasting rooms and other temporary, seasonal or year-round sales and promotion of agricultural products grown or processed in the county subject to the minimum criteria of General Plan Policies AR-6d and AR-6f. This subsection shall not be interpreted so as to require a use permit for uses allowed by Section 26-08-010(g);
- (k) Marketing accommodations in compliance with Section 26-88-086;
- (l) Dwelling unit(s) for full time agricultural employees which are transferred from another lot within this district and which are under the same ownership as the subject property. The number of units allowed shall be determined by the standards in Section 26-08-010(h)(2). The units shall be located on the receiving parcel such that they are closer to the primary dwelling unit than to the property line;
- (m) Temporary farm worker camps not permitted by Section 26-08-010(h);
- (n) Seasonal farmworker housing that does not meet the road access, occupancy, or setback standards of Section 26-88-010(l);
- (o) Year-round and extended seasonal farmworker housing that does not meet the road access, occupancy limits, parcel size or setback standards of Section 26-88-010(o);
- (p) The following nonagricultural uses; provided, that the applicant must demonstrate that the use meets a local need, avoids conflict with agricultural activities and is consistent with Objective AR-4.1 and Policy AR-4a of the agricultural resources element:
  - (1) Game preserves, refuges, and hunting clubs. Any such use on a parcel under a Williamson Act contract must be consistent with Government Code Section 51200 et seq. (the Williamson Act) and local rules and regulations,
  - (2) Public schools; private nursery, primary and secondary schools; places of religious worship; and places of public or community assembly, all subject, at a minimum, to the criteria of General Plan Policy LU-6e, except on lands subject to a Williamson Act contract.
  - (3) Campgrounds with a maximum of thirty (30) sites, provided that the subject area is not under a Williamson Act contract and subject, at a minimum, to the criteria of General Plan Policy AR-6e,
  - (4) Cemeteries, except on land subject to a Williamson Act contract,
  - (5) Commercial kennels. Any such use on a parcel under a Williamson Act contract must be consistent with Government Code Section 51200 et seq. (the Williamson Act) and local rules and regulations,
  - (6) Private landing strips. On land subject to a Williamson Act contract, such use shall be limited to that necessary for aircraft dedicated to aerial spraying and other agricultural purposes and not for private passenger aircraft for personal convenience and transportation,
  - (7) Bed and breakfast inns containing not more than five (5) guest rooms, subject to design review and compliance with Section 26-88-118,
  - (8) Minor public service uses or facilities (transmission and distribution lines and telecommunication facilities excepted), including, but not limited to reservoirs, storage tanks, pumping stations, and transformer stations. Any such use on a parcel under a Williamson Act contract must be consistent with Government Code Section 51200 et seq. (the Williamson Act) and local rules and regulations,
  - (9) Fire and police stations and training centers, service yards and parking lots which, at a minimum, meet the criteria of General Plan Policy PF-2 t and which are not otherwise exempt by state law. Such facilities are not permitted on land subject to a Williamson Act contract,
  - (10) Intermediate and major freestanding commercial telecommunication facilities subject at a minimum to the applicable criteria set forth in Section 26-88-130. Any such use on a parcel

under a Williamson Act contract must be consistent with Government Code Section 51200 et seq. (the Williamson Act) and local rules and regulations,

- (11) Noncommercial telecommunication facilities greater than eighty feet (80') in height subject at a minimum to the applicable criteria set forth in Section 26-88-130,
- (12) Exploration and development of low temperature geothermal resources for other than power development purposes provided that at a minimum it is compatible with surrounding land uses. Any such use on a parcel under a Williamson Act contract must be consistent with Government Code Section 51200 et seq. (the Williamson Act) and local rules and regulations,
- (13) Application of clean dredge material or biosolids from wastewater treatment plants subject, at a minimum, to the criteria of General Plan Policies PF-2s,
- (14) Granges and similar community service facilities which do not adversely impact agriculture in the area. Any such use on a parcel under a Williamson Act contract must be consistent with Government Code Section 51200 et seq. (the Williamson Act) and local rules and regulations,
- (15) Large residential community care facility, except on land subject to a Williamson Act contract,
- (16) Day care center, except on land subject to a Williamson Act contract,
- (17) Reserved,
- (18) Commercial wood yards, including wood splitting, except such uses are not allowed on land subject to a Williamson Act contract,
- (19) Golf courses and driving ranges shall be at the sole discretion of the county and subject, at a minimum, to the following criteria:
  - (i) The proposed use is adjacent to a designated urban service boundary or includes an irrevocable offer of offsite unutilized development rights for all lands between the use and the urban service boundary,
  - (ii) Permanent open space or agricultural preservation is provided for the site of the proposed use and all areas for which development rights are acquired,
  - (iii) The use is located in close proximity to an existing wastewater treatment facility and includes the use of reclaimed wastewater in accordance with the regulations of the applicable regional water quality control agency,
  - (iv) The use is subject to design review approval and includes setbacks, buffers or other measures designed to minimize its impact on existing and potential agricultural uses in the area,
  - (v) Under no circumstances shall housing be included as part of the use, provided that a caretaker unit may be considered,
  - (vi) The use must be compatible with and not result in limitations on any agricultural operation,
  - (vii) The use shall not be conducted on lands subject to a Williamson Act contract or included in a timber production zone,
  - (viii) Facilities associated with the golf course and/or driving range shall be limited to those which serve golfers on the course or range, such as locker and shower facilities, pro shop with incidental sales of golfing equipment, snack bar and maintenance operations. Such facilities shall not include restaurants, other retail sales, lodging, or similar uses,
  - (ix) Driving ranges shall not be operated during nighttime hours.



In the event that the above uses are proposed within a designated community separator, the criteria established by General Plan Policy OSRC-1c shall supersede the above criteria.

- (20) Craft sales and garage sales involving three (3) or four (4) sales days per year,
- (21) Small wind energy systems located within a county-designated urban service area or within two thousand five hundred feet (2,500') of a county-designated urban service area, subject to the standards in Section 26-88-135. Any such use on a parcel under a Williamson Act contract must be consistent with Government Code Section 51200 et seq. (the Williamson Act) and local rules and regulations.
- (22) Commercial composting facilities incidental to the agricultural use, subject to Policy AR-4a of General Plan agricultural resources element. Any such use on a parcel under a Williamson Act contract must be consistent with Government Code Section 51200 et seq. (the Williamson Act) and local rules and regulations;
- (q) Vacation rentals exceeding the standards in Section 26-88-120, except on lands under a Williamson Act contract;
- (r) Live/work uses in conjunction with a legally established single family residential unit subject to the requirements of Section 26-88-122. Any live/work use on a parcel under a Williamson Act contract must be consistent with Government Code Section 51200 et seq. (the Williamson Act) and local rules and regulations;
- (s) Other nonresidential uses which in the opinion of the planning director are of a similar and compatible nature to those uses described in this section;
- (t) Commercial cannabis uses in compliance with Sections 26-88-250 through 26-88-256.

(Ord. No. [6255](#), § V, 1-8-2019; Ord. No. [6245](#), § II, 10-16-2018; Ord. No. [6189](#), § II(C), 12-20-2016; [Ord. No. 6145, § V](#), 3-15-2016; Ord. No. 5964, § V, 1-31-2012; Ord. No. 5908, § II, 11-9-2010; Ord. No. 5569, § 7, 2005; Ord. No. 5435, § 2(g), 2004; Ord. No. 5429, § 3, 2003; Ord. No. 5361, § 2(k), 2002; Ord. No. 5342, § 5, 2002; Ord. No. 5265, § 1(e), 2001; Ord. No. 4973, § 3(b), 1996; Ord. No. 4781, § 2(B), 1994; Ord. No. 4643, 1993; Ord. No. 3662.)

Sec. 26-08-030. - Permitted residential density and development criteria.

The use of land and structures within this district is subject to this article, the general regulations of this chapter, and the provisions of any district which is combined herewith. Policies and criteria of the General Plan and any applicable specific or area plan or local area development guidelines shall supersede the standards herein.

- (a) Density. Residential density shall be between ten (10) and sixty (60) acres per dwelling unit as shown in the General Plan land use element or permitted by a "B" combining district, whichever is more restrictive. However, dwelling units described in Section 26-08-010(h)(2) through (6), inclusive may be permitted in addition to the residential density.
- (b) Minimum Lot Size. The minimum lot size for creation of new parcels shall be ten (10) acres, except:
  - (1) Where General Plan area policies expressly provide for a different minimum lot size;
  - (2) Where creation of smaller lots will further General Plan goals AR-3 and AR-4, objectives AR-3.1 and AR-3.2, and policies AR-3c, AR-3e and AR-4a. In such cases where lots are clustered, a protective easement shall be applied to the remaining large parcel(s) which indicates that density has been transferred to the clustered area; or
  - (3) Where creation of a smaller lot will meet the requirements of Section 26-88-180.

On parcels subject to a Williamson Act contract, the minimum parcel size shall conform to the requirements of the contract type and General Plan Policy AR-8c.

- (c) Minimum Lot Width. The minimum average lot width within each lot is one hundred twenty-five feet (125');
- (d) Maximum Building Height:
  - (1) Thirty-five feet (35') except that agricultural buildings and structures may reach up to fifty feet (50'). Additional height may be permitted provided that site plan approval in accordance with Article 82, is first secured,
  - (2) Maximum height for telecommunication facilities is subject to the provisions of this article and Section 26-88-130.
- (e) Maximum Lot Coverage.
  - (1) On parcels of two acres in size or less: twenty percent (20%);
  - (2) On parcels greater than two acres up to and including five acres in size: 18,000 SF or fifteen percent (15%), whichever is greater;
  - (3) On parcels greater than five acres up to and including 20 acres in size: 30,000 SF or ten percent (10%), whichever is greater; and
  - (4) On parcels greater than 20 acres in size: 85,000 SF or five percent (5%), whichever is greater.

Exceptions may be allowed by the planning director for commercial greenhouses, large animal operations, and buildings required for the farm operation to meet water quality or other environmental protection regulations.

- (f) Yard Requirements:
  - (1) Front or Street Side Yard. Thirty feet (30') except where combined with any B district and in no case shall the setback be less than fifty-five feet (55') from the centerline of all roads and streets, except as may be otherwise indicated on the district maps,
  - (2) Side Yard. Minimum ten feet (10'), except that in the case of a corner lot, the street side yard shall be the same as the front yard,
  - (3) Rear Yard. Twenty feet (20'),
  - (4) Watering troughs, feed troughs, accessory buildings used for the housing or maintenance of farm animals and accessory buildings and runs used for the housing or maintenance of kennel animals shall be located at least fifty feet (50') from the front property line, twenty feet (20') from any side or rear property line, and thirty feet (30') from any dwelling on the adjacent property,
  - (5) No garage or carport opening facing the street shall be located less than twenty feet (20') from any exterior property line, except that where twenty-five percent (25%) or more of the lots on any one (1) block or portion thereof in the same zoning district have been improved with garages or carports, the required front yard may be reduced to a depth equal to the average of the front yards of the such garages or carports. However, in no case shall the front yards be reduced to less than ten feet (10'). Further, the permit and resource management department director may require a use permit if the reduction might result in a traffic hazard,

Notwithstanding the above, if a residence is elevated to meet flood requirements, the space underneath the structure may be utilized for a garage or carport if it will meet building codes, even if the ten-foot (10') to twenty-foot (20') setback cannot be met, subject to approval of administrative design review,

- (6) Cornices, eaves, canopies, bay windows, fireplaces and/or other cantilevered portions of structures, and similar architectural features may extend two feet (2') into any required yard. The maximum length of the projections shall not occupy more than one-third of the total length of the wall on which it is located. Uncovered porches, fire escapes or landing places may extend six feet (6') into any required front or rear yard and three (3') feet into any required side yard,
  - (7) Where twenty-five percent (25%) or more of the lots on any one (1) block or portion thereof in the same zoning district have been improved with buildings, the required front yard may be reduced to a depth equal to the average of the front yards of the improved lots, subject to the limitations of Subsection (f)(5) of this section,
  - (8) Accessory buildings may be constructed within the required yards on the rear half of the lot; provided, that such buildings shall not occupy more than thirty percent (30%) of the width of any rear yard. Such accessory buildings shall not be located closer than ten feet (10') to the main buildings on adjacent lots. Notwithstanding the foregoing, swimming pools may occupy more than thirty percent (30%) of the width of any rear yard. A minimum of three feet (3') shall be maintained between the wall of a pool and the rear and side property lines, and from the main building on the same lot. Conventional pool accessory equipment (pump, filters, etc.) shall be exempt from setback restrictions. Additional setbacks may be required under the California Building Code.
  - (9) The yard requirements of Subsections (f)(1) or (2) of this section may be reduced up to fifty percent (50%) for agricultural buildings and structures if necessary for efficient farming operation.
- (g) In compliance with applicable sections of the State Subdivision Map Act and the Subdivision Ordinance, a two (2)-way division of a parcel of land that is currently subject to a Williamson Act contract may be allowed, if all of the following apply:
- (1) The resulting parcel is to be sold or leased for agricultural employee ("farmworker") housing, and is not more than five (5) acres in size. For the purpose of this Section, "agricultural employee" shall have the same meaning as defined by Subdivision (b) of Section 1140.4 of the Labor Code,
  - (2) The parcel shall be sold or leased to a nonprofit organization, a city, a county, a housing authority, or a state agency, for the sole purpose of the provision and operation of farmworker housing. A lessee that is a nonprofit organization shall not sublease that parcel without the written consent of the landowner, and shall notify the county of such sublease,
  - (3) The parcel to be sold or leased shall be subject to a deed restriction that limits the use of the parcel to farmworker housing facilities for not less than thirty (30) years. The deed restriction shall also provide, through reversionary or similar provision, that the parcel shall automatically revert to and be merged with the parcel from which it was subdivided when the parcel ceases to be used for farmworker housing for a period of more than one (1) year. The deed restriction shall be in a form satisfactory to county counsel,
  - (4) There is a written agreement between the parties to the sale or lease of the parcel and their successors to operate the parcel to be sold or leased under joint management of the parties, subject to the terms and conditions and for the duration of the Williamson Act contract,
  - (5) The parcel to be sold or leased is contiguous to one (1) or more parcels that are located within a designated urban service area, and which are zoned for and developed with urban residential, commercial, or industrial land uses,
  - (6) The farmworker housing project is provided pursuant to Section 26-88-010(l) (Seasonal farmworker housing) or Section 26-88-010(o) (Year-round farmworker housing), and includes provisions designed to minimize potential impacts on surrounding agricultural and rural residential land uses.

A subdivision of land pursuant to this section shall not affect any Williamson Act contract executed pursuant to Article 3 (commencing with Section 51240) of the Government Code, and the parcel to be sold or leased shall remain subject to that contract.

(Ord. No. 5964, § V, 1-31-2012; Ord. No. 5711 (Exh. H), 2007; Ord. No. 5569 § 9, 2005; Ord. No. 5082 § 1, 1997; Ord. No. 4973 § 3(c), 1996; Ord. No. 4927 §§ 1, 6, 11, 1996; Ord. No. 4643, 1993; Ord. No. 3932.)